

BF

IPSWICH BOROUGH COUNCIL

APPLICATION FOR AUTHORISATION TO CARRY OUT PRESCRIBED PROCESS
WITHIN THE CONTROL OF IPSWICH BOROUGH COUNCIL,
UNDER SECTION 6 OF THE ENVIRONMENTAL PROTECTION ACT 1990
(LOCAL AUTHORITY AIR POLLUTION CONTROL)

YOU SHOULD READ THE ENCLOSED EXPLANATORY NOTES BEFORE
COMPLETING THIS FORM

SECTION 1 Details of Operator and Location of Process

- (a) Name, address and telephone number of the applicant:-
 HOLDEN TIMBER LTD, DUKE STREET
 IPSWICH, IP3 0AF 01473 286655

- (b) Address of registered or principal office, if the applicant is a body corporate:-
 CARDINAL HOUSE
 46 ST. NICHOLAS STREET, IPSWICH IP1 1TT

- (c) Address for correspondence, if different from that in (a) above:-
 SAME

- (d) Address of the premises where the process will be carried out:-
 HOLDEN TIMBER, DUKE STREET
 IPSWICH

- (e) Details of maps and plans attached:-
 SITE PLAN

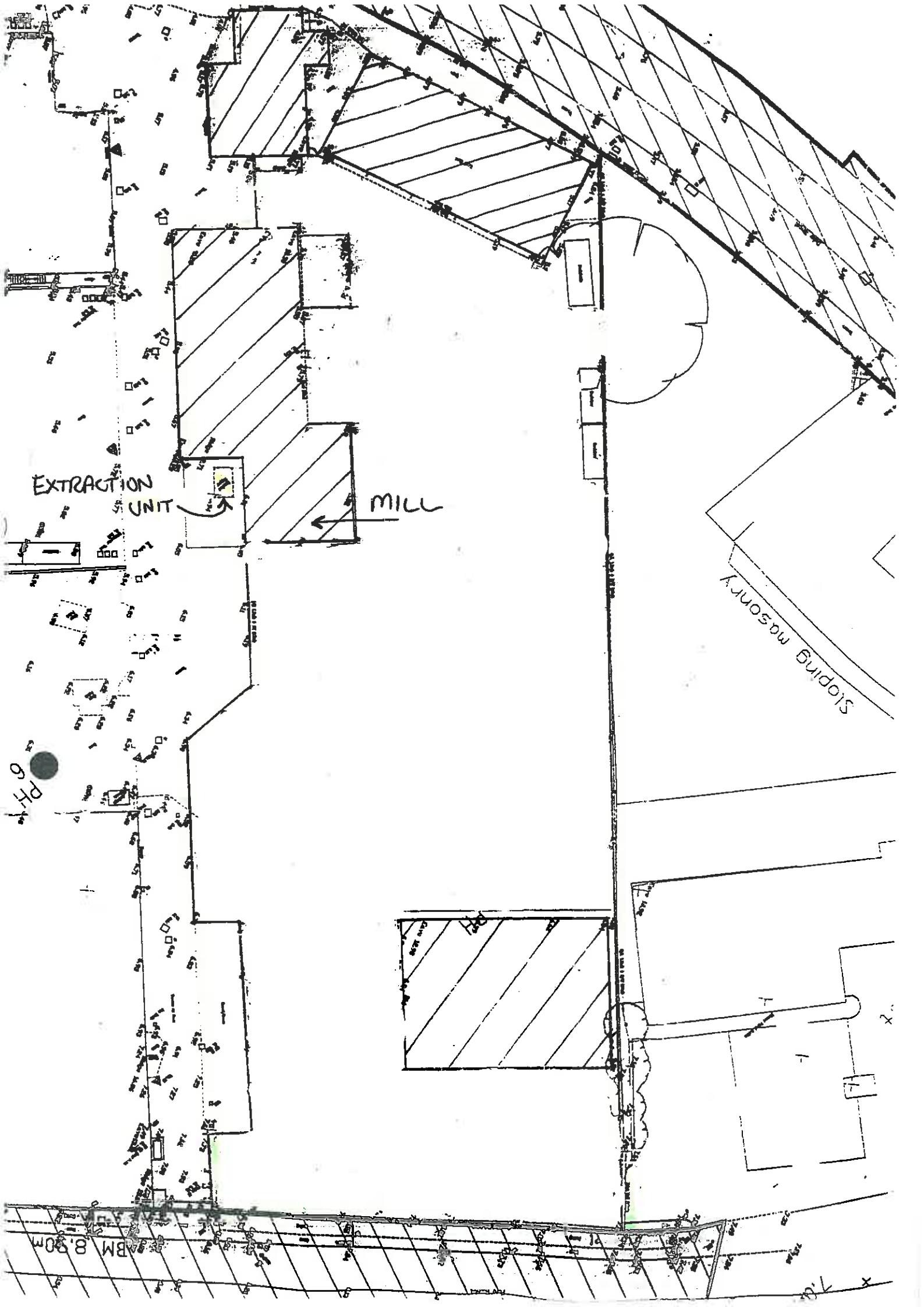

EXTRACTION UNIT

MILL

Sloping MASONRY

PH 6

BM 8.90M

SECTION 2

Description of Process and of the Proposed Techniques to Prevent or Minimise Emissions to Air of Prescribed Substances and to Render Harmless Emissions to Air of all Substances

This should include a description (with drawings, where appropriate) of physical characteristics of the process, height and location of stacks or vents and abatement technology. Also, details should be given of how the process is to be operated. (See separate explanatory notes for more detail).

SEE SEPARATE SHEET.

(Continue on a separate sheet if necessary)

Section 2

Softwood and hardwood timber is processed in the mill using band saws, planers, spindle, cross cut and sheet saw.

The machinery is operated by trained staff and under the control of the yard manager. Qualified engineers carry out regular maintenance and servicing of all the machinery.

Some machines (i.e. spindle, sheet saw and surface planer) are connected to a self-contained dust extraction system within the mill.

The following machines are connected to the main extraction system:

Stenner 36 Band saw – 4" x 17.8

Stenner VHM 36 Band saw - 3" x 18.4

Weinig Q23v Planer

Wadkin S105 Cross cut saw.

A motor inside the mill draws dust from the machines and blows it into the extraction unit situated outside the mill.

The extraction system was designed by Ashcraft Environmental (Tel 01327 300777).

This is a 2 module 'x' rotary valve filter unit with 32no 8" diameter x 7'6" long 350g polyester needle felt filter sleeves giving 500 sq ft (46m²) of filter area. It is a 15HP machine with an 18" paddle blade capable of a max 4500 cubic ft per minute.

The air outlet is through 2 no. cowls at the top of the unit.

Filter cleaning is achieved by 2no. hand operated shaker cords.

The dust discharges through a rotary valve directly into a purpose designed closed skip (supplied by AEWS).

The dust skip has a 40yd capacity and is exchanged approximately once every 4 weeks.

The extraction motors and saws etc. are switched off whilst the skip is exchanged.

If the skip is not connected or if the extraction system fails the machines will not be used.

A member of the mill staff visually checks the level in the skip daily. Daily checks are made to ensure the system is functioning correctly.

Any escape of dust would be easily seen by staff and would be immediately rectified.

Maintenance of the system requires monthly visual inspection to the filters and to the bearings.

Previously the dust extraction was connected through a further hopper and fan to a purpose built trailer incorporating built in vents.

We believe the current system is the Best Available Technique Not Entailing Excessive Cost.

SECTION 3

Details of the Source, Nature and Amount of Current and/or Anticipated Air Emissions from the Process

(Include non-prescribed substances, as well as prescribed substances)

Section 3

The timber processed is mainly softwood with some hardwood such as sapele, iroko, oak and small quantities of other hardwoods.
No MDF is processed in the mill.

Sawn Timber

Approximately 3000m³ of softwood carcassing passes through the yard per year, about 33% is sawn, the rest is sold unprocessed.

Total timber sawn per year	1000m ³
----------------------------	--------------------

Planed / Machined Timber

Approximately 50m³ of hardwood are sold per year, only 50% of which is machined,

25m³

1000m³ of pse are sold, only 5% of which is machined,

50m³

150m³ of softwood joinery are sold, 25% is machined,

37.5m³

Total timber planed etc. per year	117.5m ³
-----------------------------------	---------------------

The mill produces approx. 1no. 40yrd skip per 4 weeks.

(Continue on a separate sheet if necessary)

SECTION 4

Details/Proposals for Monitoring, Sampling and Measurement of Air Emissions

Applicants should propose the type and frequency of monitoring they expect to carry out, in order to meet the requirements of the EPA.

Section 4

The exhaust air from this system is less than 300m³/min.
Therefor we feel a visual assessment of emissions will be adequate.
This will be done at least once a day.
Any excessive emissions, the causes and action taken will be recorded.

(Continue on a separate sheet if necessary)

SECTION 5

Assessment of the Likely Environmental Consequences of any Emissions to Air

Applicants should aim to show that their process achieves BATNEEC. The assessment should be limited to considering the effects of air emissions on the environment. (See separate explanatory notes for more detail.)

Section 5

Environmental Consequences

Holden Timber is aware of the environmental impact of timber processing and has made reasonable efforts to minimize the dust emissions. Improvements have been made to previous systems to increase efficiency and to reduce the escape of dust into the air.

We feel that the volumes of timber processed in the mill is close to the threshold for this application and the level of filtration together with the waste management is more than adequate for amount of dust produced.

Holden Timber has therefor a minimal effect on polluting the environment.

We will ensure the system is operated and maintained correctly, and any faults rectified immediately.

We would however be happy to consider any further improvements to meet current and future guidelines.

(Continue on a separate sheet if necessary)

Name of Newspaper in which it is proposed to advertise the application:-

EAST ANGLIAN DAILY TIMES

Fee enclosed:- (cheques made payable to Ipswich Borough Council)

£ 1303-00

I hereby certify that all the information contained in this application is, to the best of my knowledge, correct.

SIGNATURE:

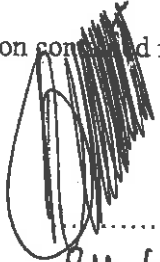

NAME IN BLOCK CAPITALS:

R.M. HOLDEN

CAPACITY IN WHICH SIGNING:

UD

DATE:

01/08/03